

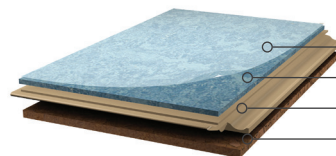

F **FLOATING**
eco friendly
floating floor

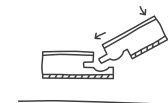

High resistance
LINO SHIELD®
Linoleum top layer
High-density fiberboard
Cork granulate underlayment



**Just 100%
natural**



CLASS 32



ANTI-SLIPPERY



EASY TO INSTALL



GLUELESS INSTALLATION



OK RADIANT HEATING



RESISTANT

COLLECTIONS	MURANO
Dimensions EN 427	900 x 300 x 11 mm
Flooring according to EN 685	23 / 32
Thickness EN 428	11 mm
Weight EN 430	10 Kg/m ²
Static Charge EN 1815	< 2 kV
Fire classification according to EN 13501-1	Cf1 S1
Thermal Insulation value EN 12524	0.17 W/m-K
Dimensional Stability EN 434	< 0,1%
Indentation EN 433	0.07
Determination of the Slippery Resistance EN 13893	DS: => 0.30
HDF thickness swelling 24 hours EN 317 B1	< 8%
Determination of the effect of a castor chair EN 425	Suitable for office Chairs with castors



UNICLIC

